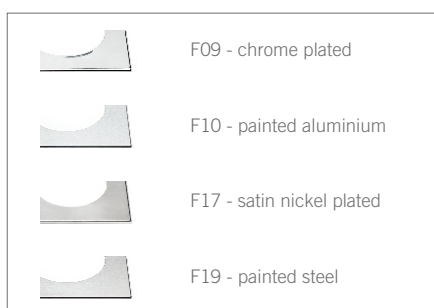
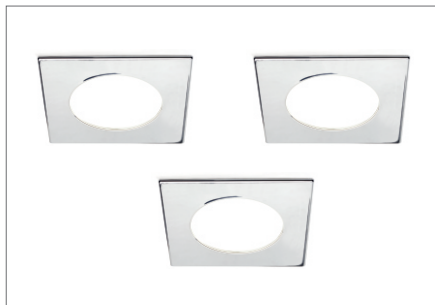

SET CUBIT PLUS 3X

www.domusline.com

LED spotlights SET
for diffused lighting

| Device with non-replaceable LED module

**Product features**

Housing:	thermoplastic polymers
Diffuser:	PMMA
Wiring:	2000mm Plug & Play
Connector:	Micro12
LED Converter:	included
Switch:	not included
N. LEDs:	33
Durability:	50,000 h ¹

Technical Data²

Wattage:	3 W
Voltage:	12 Vdc
Insulation degree:	III
Socket/Type:	LED

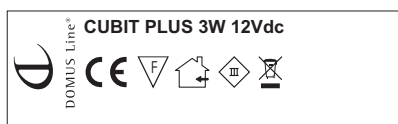

Referred to CUBIT PLUS luminaires

Marks and symbols

CE	Device in compliance with the EN60598 regulation-last edition.
	Protection class III device. Power must be supplied by a safe power supply (in accordance with the EN61347-2-13 standard).
	Device suitable for mounting in or on normally flammable surfaces.
	Device only for indoor installation.
	Device subject to the European Community directives 2002/96/CE and 2003/108/CE.

¹ average value (minimum guaranteed complies with the requirements of EU Regulation 1194/2012)
² referred to CUBIT PLUS luminaire

**SET CUBIT PLUS 3X**LED spotlights SET
for diffused lighting

| Device with non-replaceable LED module

Code	Watt & Volt	Light colour	Finish	EAN	Intrastat Number
2227709N	3x3W @ 230Vac	natural white	white		94054099
2227709B	3x3W @ 230Vac	warm white	white		94054099
2227709B1	3x3W @ 230Vac	super warm white	white		94054099
Code	Watt & Volt	Light colour	Finish	EAN	Intrastat Number
2227710N	3x3W @ 230Vac	natural white	chrome		94054099
2227710B	3x3W @ 230Vac	warm white	chrome		94054099
2227710B1	3x3W @ 230Vac	super warm white	chrome		94054099
Code	Watt & Volt	Light colour	Finish	EAN	Intrastat Number
2227717N	3x3W @ 230Vac	natural white	aluminium		94054099
2227717B	3x3W @ 230Vac	warm white	aluminium		94054099
2227717B1	3x3W @ 230Vac	super warm white	aluminium		94054099
Code	Watt & Volt	Light colour	Finish	EAN	Intrastat Number
2227719N	3x3W @ 230Vac	natural white	satin nickel		94054099
2227719B	3x3W @ 230Vac	warm white	satin nickel		94054099
2227719B1	3x3W @ 230Vac	super warm white	satin nickel		94054099



Scan for installation manual

LED CONVERTER INCLUDED.**Micro 12**polarized connector
for 12Vdc luminaire**230V**feeding by
constant voltage Converter

SET CUBIT PLUS 3X

www.domusline.com

LED spotlights SET
for diffused lighting

| Device with non-replaceable LED module

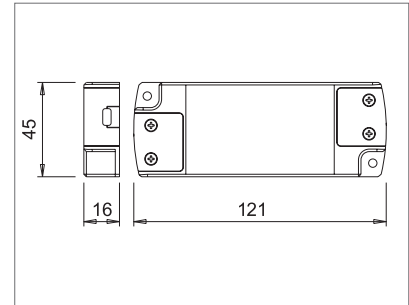
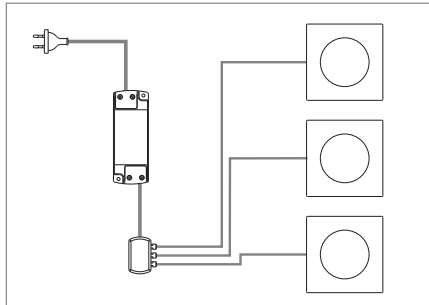
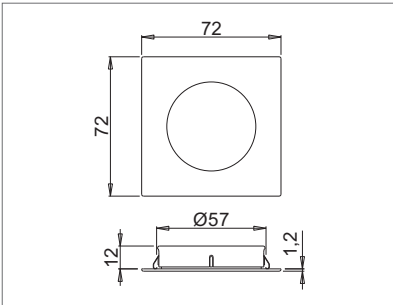

Scan for more info
about LED Converter

Photometric Data³

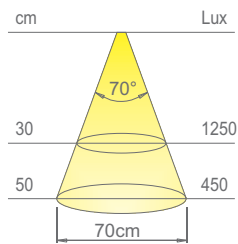

Colour appearance: natural white
Color temperature: 4300 Kelvin
Luminous flux: 390 lm
Luminous efficiency: 130 lm/W
CRI: Ra 80
Binning: Variation of chromaticity coordinates within a MacAdam ellipse

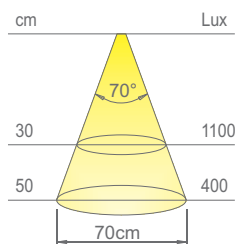

Colour appearance: warm white
Color temperature: 3000 Kelvin
Luminous flux: 360 lm
Luminous efficiency: 120 lm/W
CRI: Ra 80
Binning: Variation of chromaticity coordinates within a MacAdam ellipse

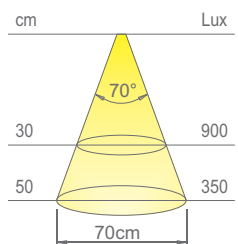

Colour appearance: super warm white
Color temperature: 2700 Kelvin
Luminous flux: 360 lm
Luminous efficiency: 120 lm/W
CRI: Ra 80
Binning: Variation of chromaticity coordinates within a MacAdam ellipse

³_average value (minimum guaranteed complies with the requirements of EU Regulation 1194/2012)

SET CUBIT PLUS 3X

www.domusline.com

LED spotlights SET
for diffused lighting

| Device with non-replaceable LED module

Configuration

The CUBIT PLUS configuration is equipped with **Plug&Play system**.
The power cord can be easily unplugged from spotlight.

PATENTED



Energy label



CUBIT
DOMUS Line®



This luminaire contains built-in LED lamps.

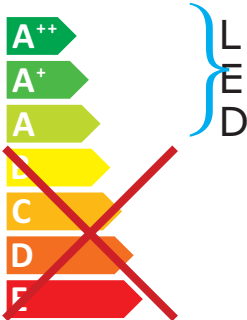

The lamps cannot be changed in the luminaire.

874/2012





Scan for more info

Compliance

Standards : EN 60598-1:2009 EN 55015:2006+A1:2007+A2:2009
 EN 60598-2-2:1997 EN 61547:2009
 EN 62031:2009 EN 61000-3-2:2006+A1:2009+A2:2009
 EN 62471:2008 EN 61000-3-3:2013

European Directives : 2014/35/EU Low Voltage
 2014/30/EU EMC
 2009/125/CE Erp (1194-2012-CE)
 2011/65/UE RoHS

Photobiological Safety: risk 0 (free)

Certificate/s:

Packaging data

	Pcs	Dimensions LxWxH (mm)	Gross weight	Net weight
Packaging unit:	1 pcs	250X130X60	0,407 Kg	0,346 Kg
Multibox unit:	20 pcs	530x290x350	8,768 Kg	6,931 Kg