



## K-PAD

Domus Line  
design

### LED luminaire for under cabinet lighting

**Materials:**

PMMA, thermoplastic polymers

**Finishes:**

aluminium, steel, black touch,  
white matt, lead

**Light source:**

LGP LED module

**Wiring:**

2000mm

**Application type:**

under cabinet, under shelf

**Installation:**

surface

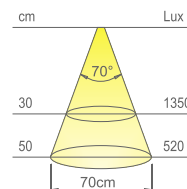
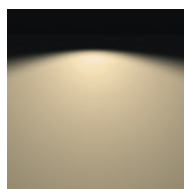
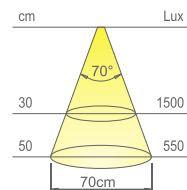
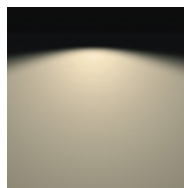
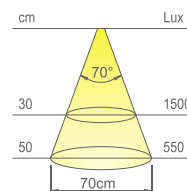
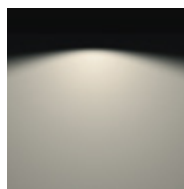

**Colour appearance** natural white  
**Colour temperature** 4000 K  
**Luminous flux** 275 lm  
**Luminous efficiency** 55 lm/W  
**CRI** Ra ≥ 80

**Colour appearance** warm white  
**Colour temperature** 3100 K  
**Luminous flux** 275 lm  
**Luminous efficiency** 55 lm/W  
**CRI** Ra ≥ 80

**Colour appearance** super warm white  
**Colour temperature** 2800 K  
**Luminous flux** 265 lm  
**Luminous efficiency** 53 lm/W  
**CRI** Ra ≥ 80



**K-PAD**  
without switch



Code	Watt & Volt	Light colour
12589__N/1	5W @ 24Vdc	natural white
12589__B/1	5W @ 24Vdc	warm white
12589__B1/1	5W @ 24Vdc	super warm white

Code	Finish
05	aluminium
19	steel
46	black touch
54	white matt
55	lead

**LED CONVERTER NOT INCLUDED. TO BE ORDERED SEPARATELY.**



**K-PAD** is a surface luminaire for under cabinet lighting that integrates a special **LGP LED** cluster which offers a wide and diffused light projection.

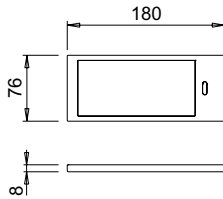

For Tunable White versions, see the Tunable White & White Changeable collection catalogue.



**K-PAD SDM**  
with master touchless switch



Code	Watt & Volt	Light colour
12589__N/2	5W @ 24Vdc	natural white
12589__B/2	5W @ 24Vdc	warm white
12589__B1/2	5W @ 24Vdc	super warm white

Code	Finish
05	aluminium
19	steel
46	black touch
54	white matt
55	lead

**LED CONVERTER NOT INCLUDED. TO BE ORDERED SEPARATELY.**



**K-PAD SDM** incorporates an electronic infrared switch that turns on, off and adjusts the luminous intensity of the luminaire.

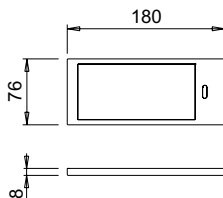

SETS OF 2, 3, 4, 5 **K-PAD** AND POWER SUPPLY ARE AVAILABLE ON REQUEST.

**FINISHES**



**ALUMINIUM** (code 10)



**STEEL** (code 19)



**BLACK TOUCH** (code 46)



**WHITE MATT** (code 54)



**LEAD** (code 55)

For power supplies and accessories see page 46 or browse the Domus Extra catalogue.



<sup>1</sup> For UL-certified model codes, see the **American standard LED collection catalogue**, also available at [www.domusline.com](http://www.domusline.com)

